

VESTEL WHITE GOODS	DOUBLE DOOR - 263	CUSTOMER SUPPORT
	INTERIOR PARTS LIST	

POSITION NUMBER	PART NAME
3	TOP HINGE/260 (WITH PIN)
4	TOP HINGE/260 (WITHOUT PIN)
6	HEAD PANEL/260
7	SCREW TT M5x14 YSB-F
8	SCREW ST 4.2*13 YHB-C
9	MIDDLE HINGE/260
12	MIDDLE HINGE SCREW CAP (BIG)
13	DOOR SWITCH
14	TUNNEL DRAIN PLUG
15	BOTTOM HINGE/140
16	STATIONARY FOOT
17	ICE SCRAPER (OPTIONAL)
18	ICE TRAY (OPTIONAL)
19	F COMPARTMENT SHELF/2601
21	THERMOSTAT BOX ASSY/260 (WITH SWITCH)
22	LAMP (E14/220-240V/15W)
23	LAMP HOLDER-E14
25	SCREW KA 40*13 YSB-R-C-INOX
26	THERMOSTAT BOX/140 (SWITCH)
27	THERMOSTAT
28	LAMP COVER/140
29	THERMOSTAT KNOB SRGF/260 (NUMBER)
30	THERMOSTAT KNOB SPRING
31	THERMOSTAT BOX SCREW CAP/140
32	SCREW KA 40*18 YSB-C-INOX
35	WIRING HARNESS/THERMOSTAT/260
37	R COMPARTMENT SHELF/263
40	CRISPER COVER TRIM/140
41	CRISPER
164	DOOR HANDLE SCREW CAP

SEPTEMBER 2016

VESTEL WHITE GOODS	DOUBLE DOOR - 263	CUSTOMER SUPPORT
	DOOR ASSY. PARTS	

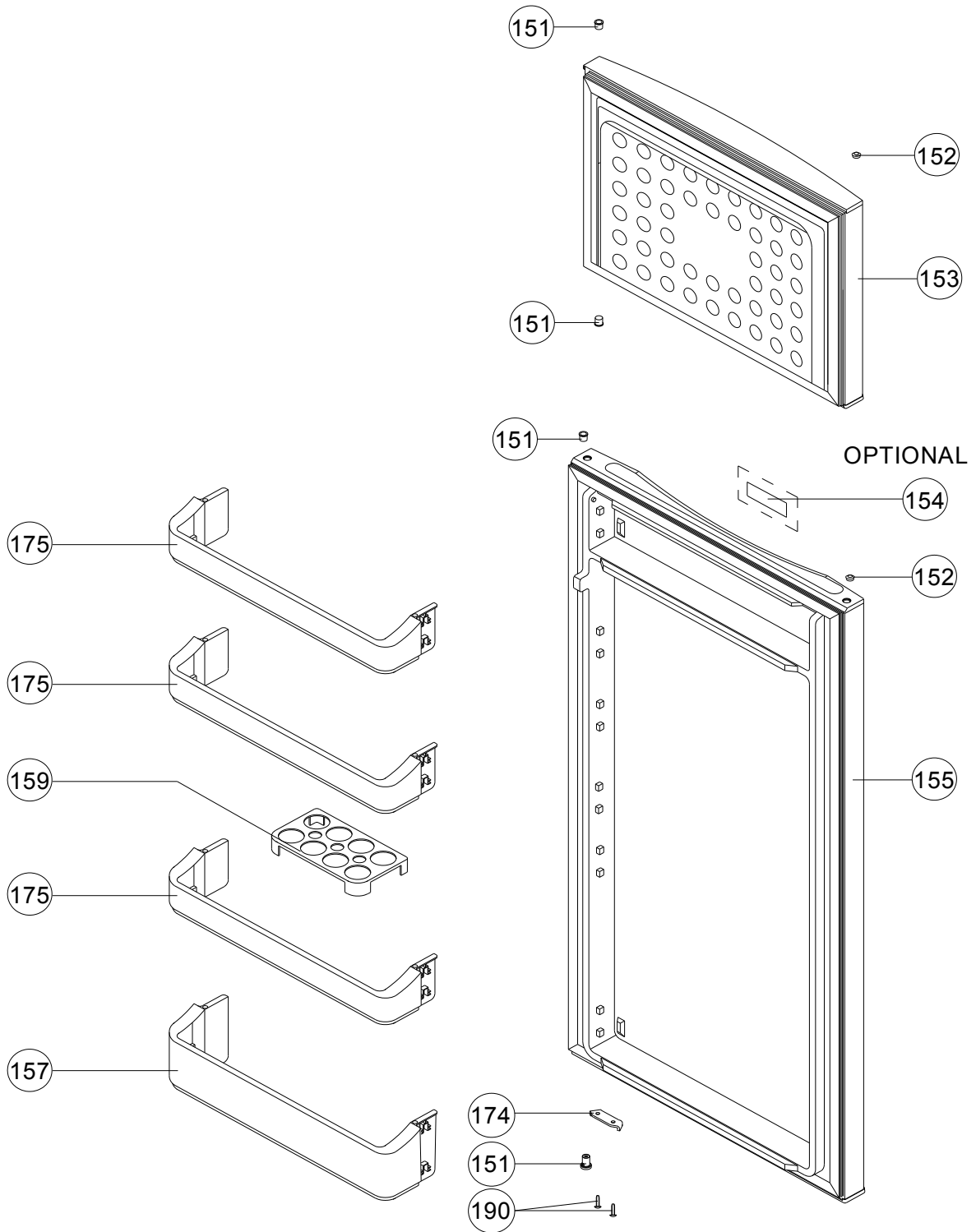

SEPTEMBER 2016

VESTEL WHITE GOODS	DOUBLE DOOR - 263	CUSTOMER SUPPORT
	DOOR ASSY. PARTS LIST	

POSITION NUMBER	PART NAME
151	BUSHING/345P
152	BUSHING CAP
153	F DOOR ASSY/263V
154	LOGO (<i>OPTIONAL</i>)
155	R DOOR ASSY/263V
157	BOTTLE SHELF
159	EGG HOLDER
174	R/D BOTTOM STOPPER/140CE
175	CHEESE/BUTTER SHELF
190	SCREW 35*12 YSB-R-C

ABBREVIATIONS :

ASSY : ASSEMBLY
 R : REFRIGERATOR
 F : FREEZER

SEPTEMBER 2016

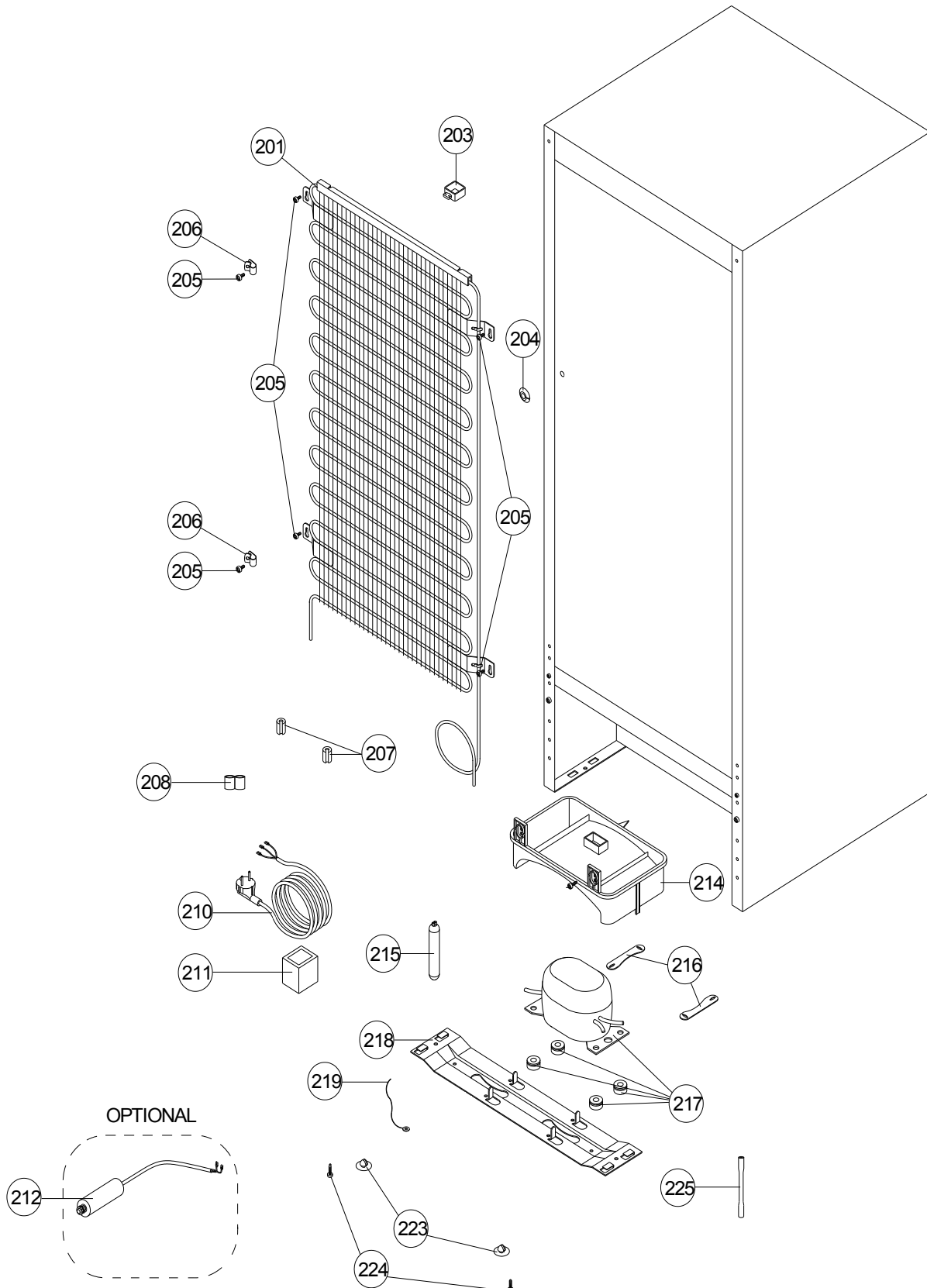

SEPTEMBER 2016

VESTEL WHITE GOODS	DOUBLE DOOR - 263	CUSTOMER SUPPORT
	UNIT PARTS LIST	

POSITION NUMBER	PART NAME
201	MAIN CONDENSER
203	SPACER
204	PLUG,CABLE HARNESS
205	SCREW ST 4.8*13 YSB-T-C
206	CABLE HOLDER / 140
207	ANTIVIBRATION (CONDENSER)
208	CONDENSER HOLDER (2)
210	POWER CORD
211	OVER LOAD RELAY
212	CAPACITOR (<i>OPTIONAL</i>)
214	EVAPORATING TRAY
215	DRYER (XH9,7.5GR)
216	COMPR. FIXING BRACKET
217	COMPRESSOR
218	COMPR. BASEMENT/140
219	GROUNDING WIRE
223	COMPR. BASEMENT FOOT/140
224	SCREW KA 50*14 YSB-F
225	SERVICE TUBE

SEPTEMBER 2016