

VESTEL WHITE GOODS	373 ELECTRONIC	CUSTOMER SUPPORT
	INTERIOR PARTS LIST	

POSITION NUMBER	PART NAME
2	TOP HINGE MEC /2451
9	HINGE MIDDLE/473
16	ADJUSTABLE FOOT M8X35
18	ICE TRAY COMMON
18A	F SHELF TOP/373 RV1
18B	F SHELF BOTTOM/373 RV1
37	R GLASS SHELF/373
37A	FOLDABLE GLAS SHELF GR./373-FRONT
37B	FOLDABLE GLASS SHELF GR./373-BACK
38	R.GLASS SHELF FRONT EXT/366
39	CRISPER GLASS SHELF/373
40	CRISPER FLAP GR/373
41	CRISPER GR/373
71	WINE SHELF 373
89A	HINGE COVER 2451
333	CRISPER ROLLER/540
339	CHILLER GR/373
641	BOTTOM HINGE GR/373
722	BOTTOM BASKET GR./373
725	TOP BASKET GR./373
726	CRISPER RAIL RIGHT/373
727	CRISPER RAIL LEFT/373
753	CHILLER RAIL LEFT/373
754	CHILLER RAIL RIGHT/373

MAY 2017

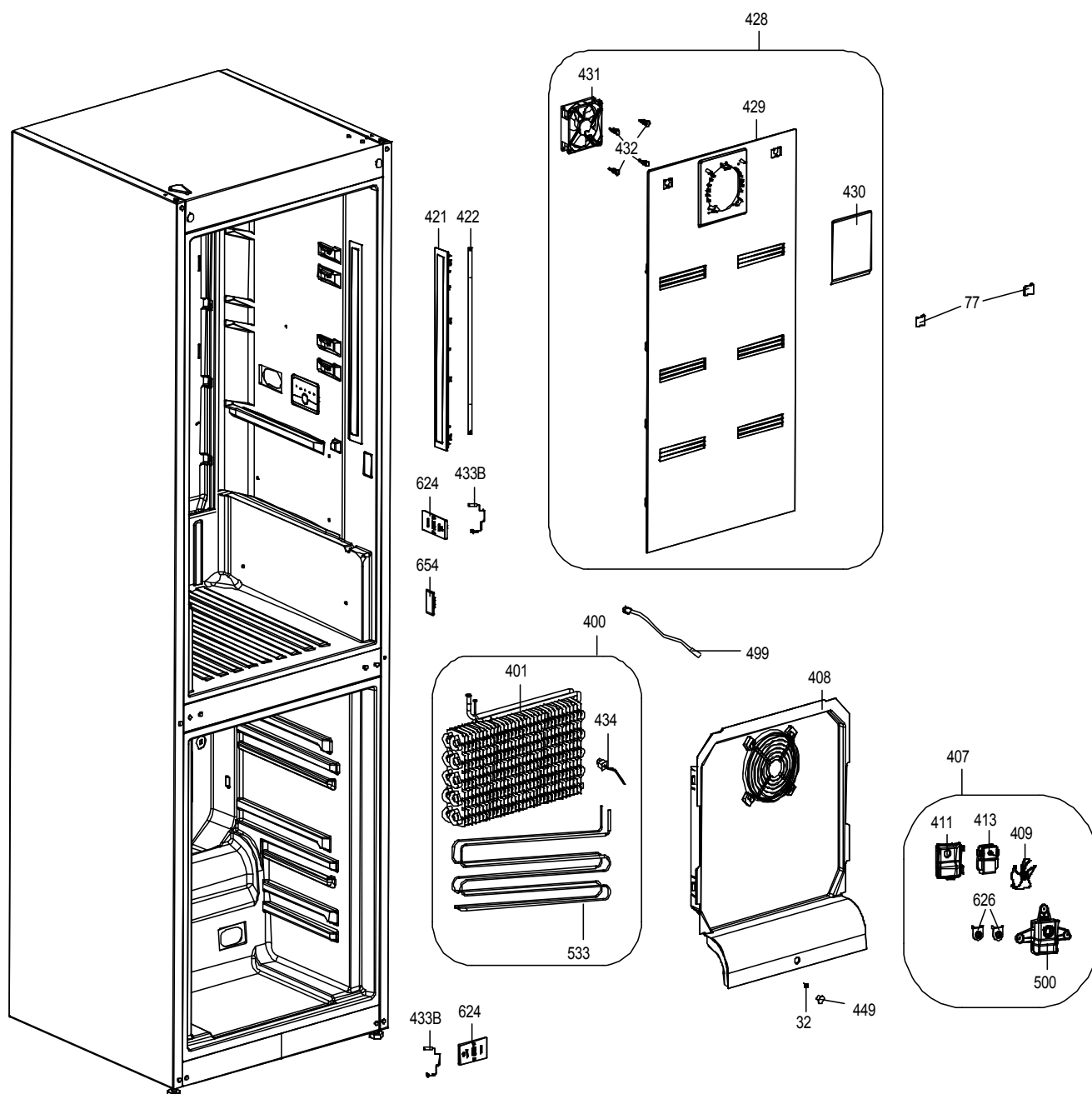

VESTEL WHITE GOODS	373 ELECTRONIC	CUSTOMER SUPPORT
	MULTIFLOW PARTS LIST	

POSITION NUMBER	PART NAME
32	SCREW KA 40*18 YSB-C-INOX
77	HEAD PANEL CAP/2451S
400	FIN EVAP.ASSY/353-373
401	FIN EVAPORATOR/353-373
407	F FAN MOTOR GR/463
408	F MULTIFLOW GR/373
409	FAN PROPELLER120MM CCW /473
411	F FAN MOTOR COVER/370
413	FREEZER FAN MOTOR / AC 463
421	LED COVER GR/373
422	LED STRIP/COOL.463/12*3014/12V
428	R MULTI FLOW ASSY/373
429	R MULTI FLOW /373
430	COOLING FAN COVER/473
431	TUR.FAN MOTOR
432	MOTOR FAN KAU.916-NEW
434	F SENSOR/540
449	R MULTIFLOW CAP/ 640
500	F FAN MOTOR BOX/370
533	FIN EVAP HEATER/373/230V/124W
624	SENSOR COVER 473
626	FREEZER FAN MOTOR RUBBER/590UHS
654	REED SWITCH GR/590UHS
433B	AMBIENT SENSOR / ELECTROMECHANIC

MAY 2017

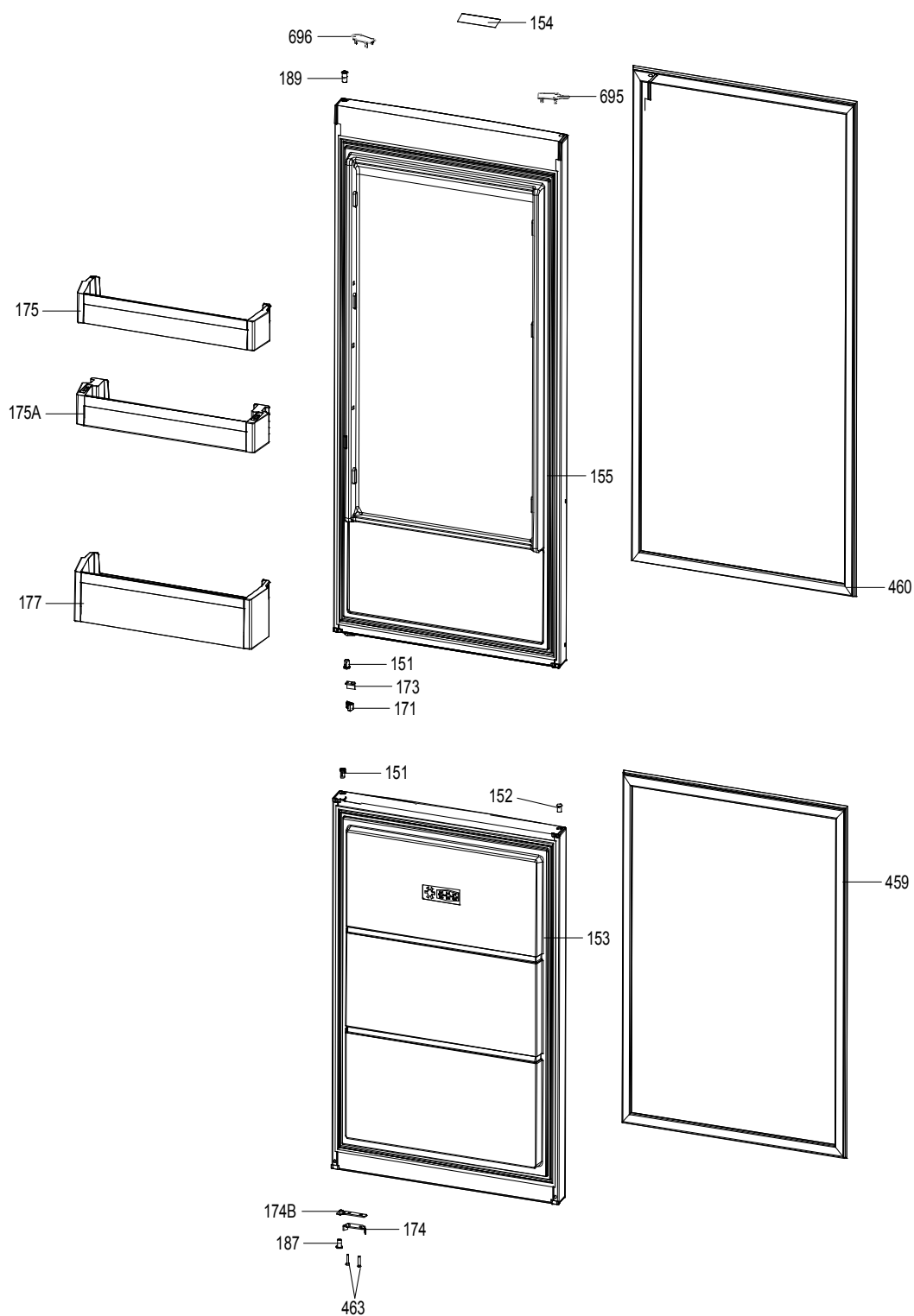

ELECTRONIC CONTROL

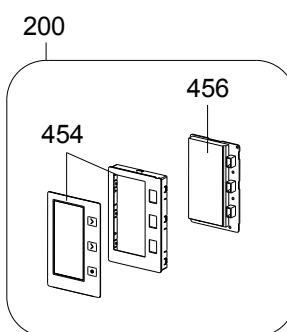

VESTEL WHITE GOODS	373 ELECTRONIC	CUSTOMER SUPPORT
	DOOR ASSY. PARTS LIST	

POSITION NUMBER	PART NAME
151	BUSHING/345
152	BUSHING CAP
153	F DOOR ASSY/373-AGE
154	LOGO
155	R DOOR ASSY/373E-AGE-FLAT
159	EGG HOLDER
171	STOPPER REINFORCEMENT PLS. 373
173	DOOR CATCHER STOPPER/473
174	R BOTTOM STOPPER/HC
174B	R BOTTOM STOPPER REINFORCEMENT 473
175A	ADJUSTABLE DOOR SHELF GR/373
175	CHEESE/BUT.SHELF/373
177	BOTTLE SHELF/373
200	DISP.PAN.GR/FLAT
187	BUSHING/345CE
189	BUSHING/540CE
454	DISPLAY LENS GR.
456	DISPLAY/BDD09-2
459	R DOOR GASKET/373 H
460	F DOOR GASKET/373 H
463	SCREW TT M5*20 YHB-F
695	R/D PANEL COVER 373 RIGHT
696	R/D PANEL COVER 373 LEFT

ABBREVIATIONS :

ASSY : ASSEMBLY
 R : REFRIGERATOR
 F : FREEZER

MAY 2017

VESTEL WHITE GOODS	373 ELECTRONIC	CUSTOMER SUPPORT
	WATER TANK GROUP (OPTIONAL)	

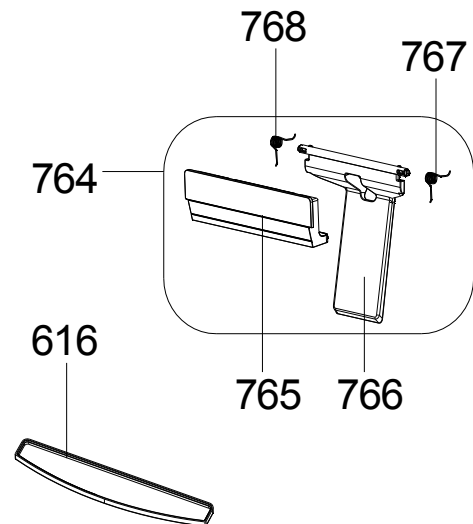
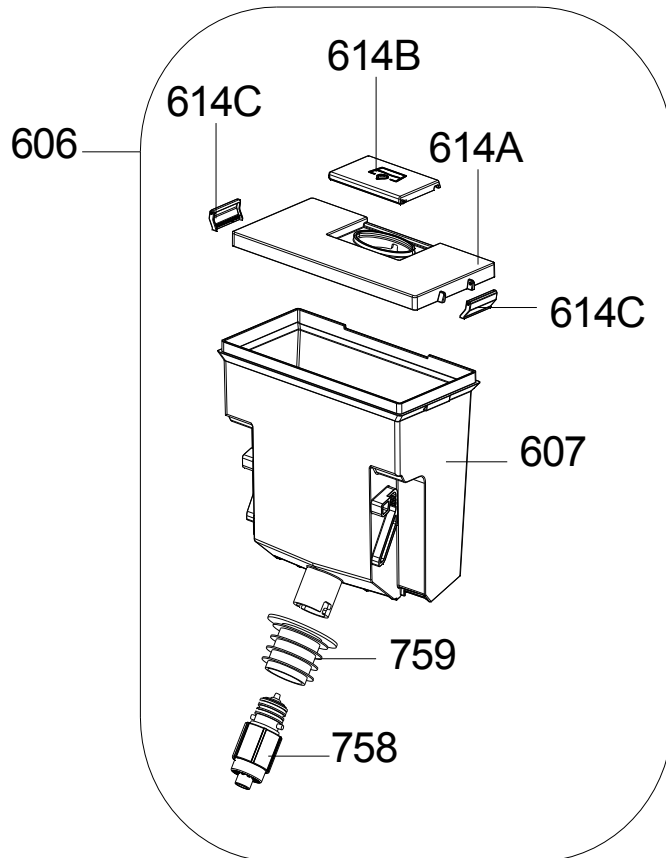

VESTEL WHITE GOODS	373 ELECTRONIC	CUSTOMER SUPPORT
	WATER TANK GROUP PARTS LIST	

POSITION NUMBER	PART NAME
606	WATER DISPANSER SLIM BACK GR
607	WATER DISPANSER SLIM TANK
758	WATER DISPENSER VALVE GR./373
759	WATER DISPENSER SLIM TANK TUBE GASKET
764	WATER DISPANSER SLIM COS GR
765	WATER DISPANSER SLIM COS.PART
766	WATER DISPANSER SLIM PUSHER PAWL
767	WATER DISPANSER SLIM SPRING LEFT
768	WATER DISPANSER SLIM SPRING RIGHT
614A	WATER DISPANSER SLIM BIG COVER
614B	WATER DISPANSER SLIM SMALL COVER
614C	WATER DISPANSER SLIM SIDE COVER

MAY 2017

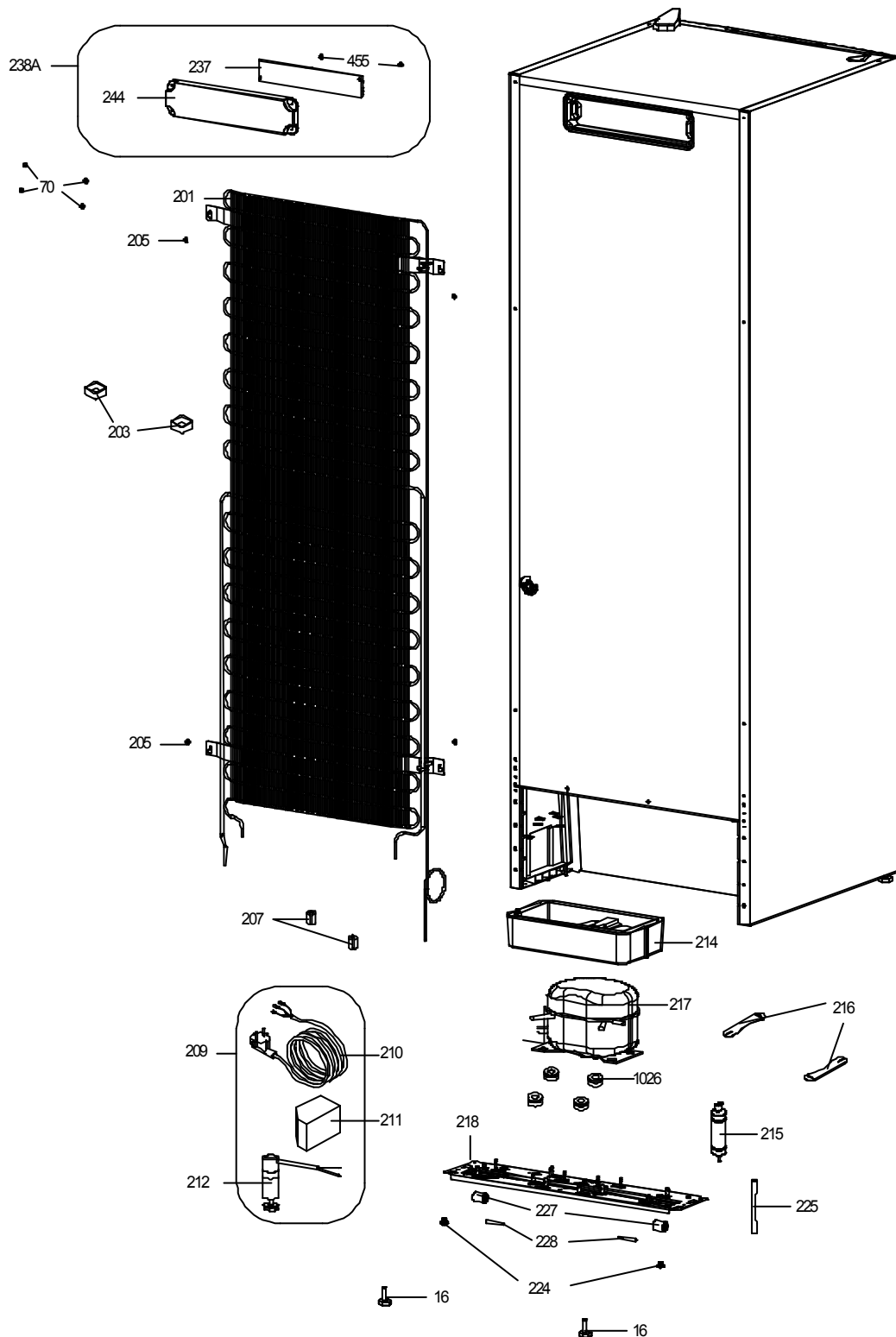

VESTEL WHITE GOODS	373 ELECTRONIC	CUSTOMER SUPPORT
	UNIT PARTS LIST	

POSITION NUMBER	PART NAME
70	SCREW KA 40*14 YSB-R-F-INOX
201	MAIN CONDANSER/345((D50-IR)
203	SPACER(NAT)
205	SCREW ST 4.8*13 YSB-T-C
207	ANTIVIBRATION (CONDANSER)
209	POWER CORD GR
210	POWER CORD
211	OVER LOAD RELAY
212	CAPACITOR
214	EVAPORATING TRAY
215	DRYER
216	COMP FIXING BRACKET
217	COMPRESSOR
218	COMP BASEMENT/345
224	SCREW KA 50*14 YSB-F
225	SERVICE TUBE
237	MB/BDA02/373EA++/R4/V29.24-23332233
244	MAINBOARD COVER 3663E/V0
455	SCREW KA 30*6 YSB-F
1026	COMPRESSOR RUBBER
238A	MAINBOARD COVER GR 373E

MAY 2017