

HÆGER

Double Door Refrigerator
Model : KD-212F

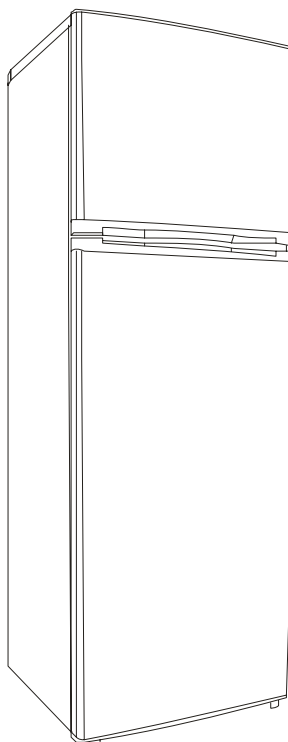

SERVICE MANUAL

Specification: Subject to change without notice.

ISSUED BY: Han Liqun Service Admin.	REVIEWED BY: Yu Jian Chief Engineer	REVISION 1.0 10 March 2009 Controlled Document
--	--	--

PRODUCT SPECIFICATION

Model	KD-212F
Classification	Double Door, Direct Cool
Color/Door	Paint Coated Metal (PCM)
Body Finish	Baked Acrylic Powder Coat
Temperature Control	Thermostat
Defrost System	Manual Defrost
Drain	Manual Drain
Evaporator	Tube Type
Condenser	Pipe Condenser

CIRCUIT DIAGRAM KD-212F

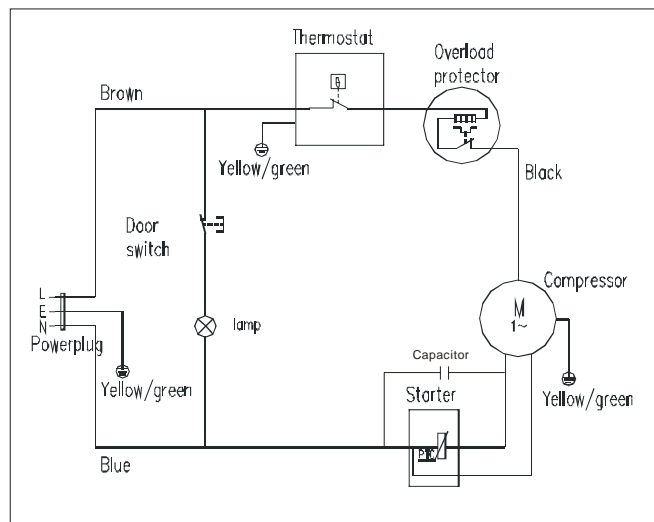

COOLING SYSTEM *KD-212F*

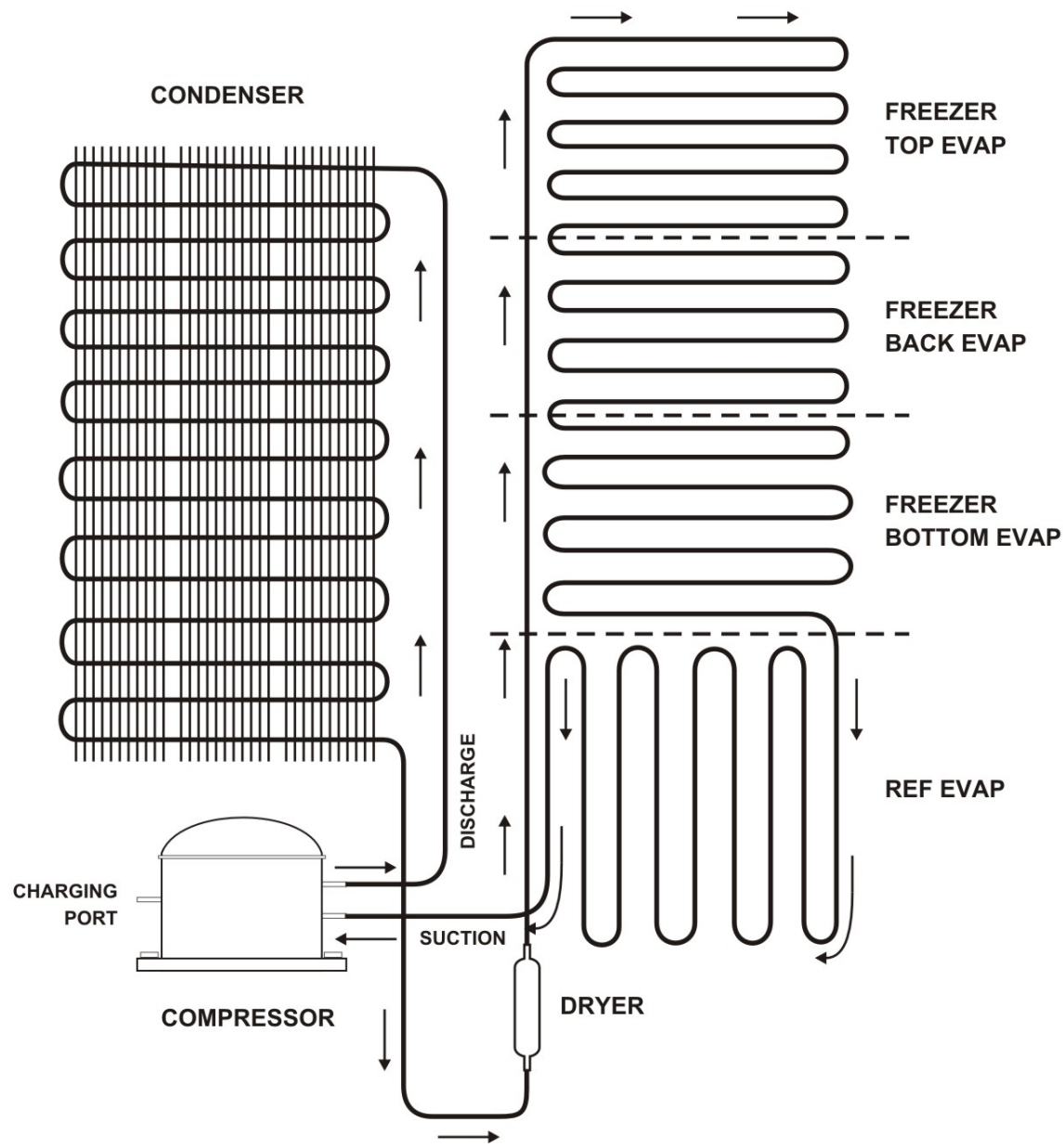

PARTS DIAGRAM KD-212F

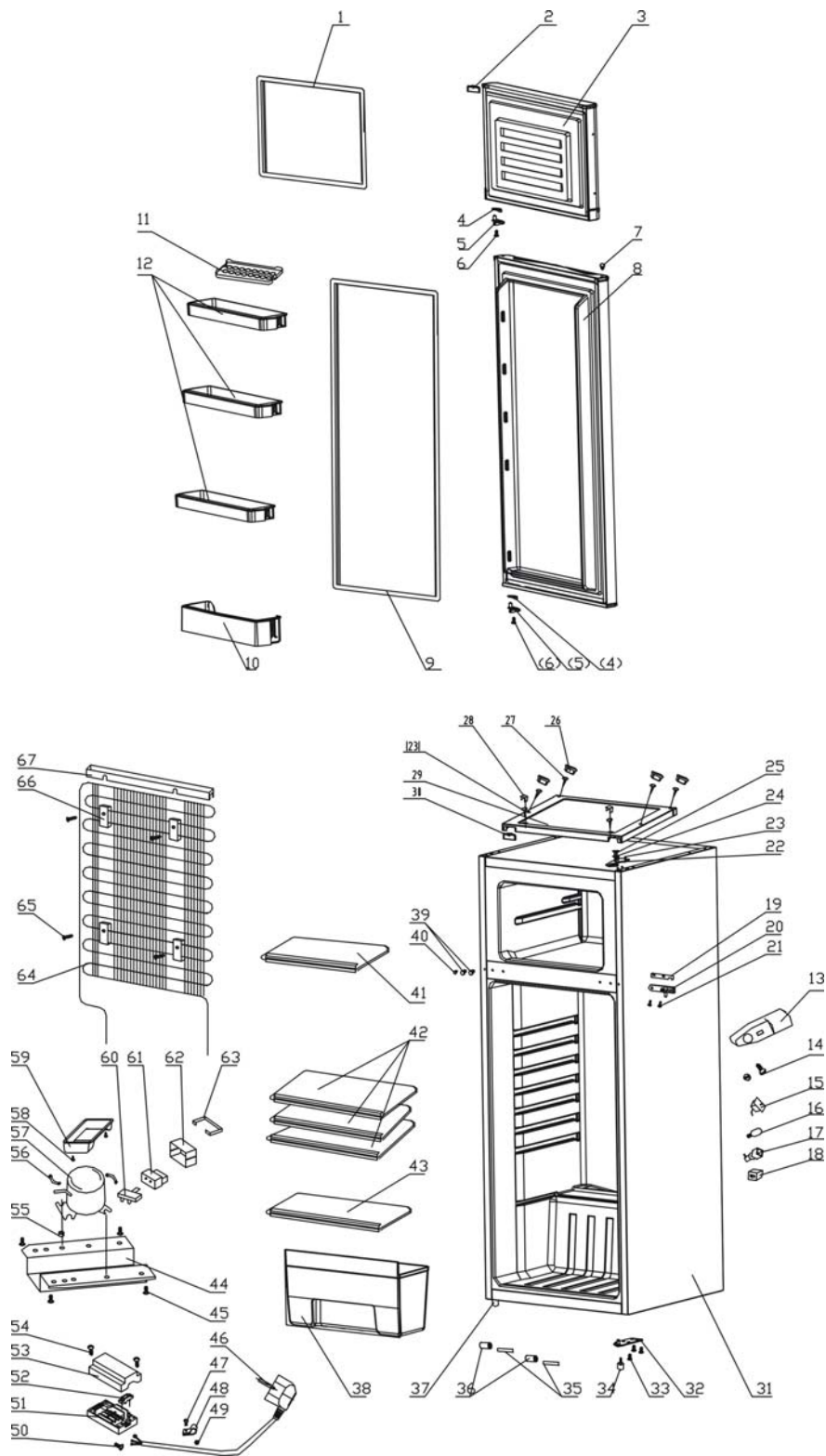

PARTS LIST TFP300W

No.	PARTS NAME	PARTS CODE	QTY.
01	Freezer Door Gasket		1
02	Door Clip		1
03	Freezer Door		1
04	Hold lump		2
05	Lock lump		2
06	Tapping Screw		2
07	Door Cover		1
08	Fridge Door		1
09	Fridge Door Gasket		1
10	Bottle Shelf		1
11	Egg Shelf		1
12	Bottle Shelf		3
13	Thermostat Cover		1
14	Cover Fixed Screw		2
15	Thermostat		1
16	Lamp		1
17	Lamp Holder		1
18	Lamp Switch		1
19	Hinge Washer		1
20	Mid Hinge		1
21	Mid Screw		2
22	Upper Hinge		1
23	Hinge Screw		3
24	Gasket		1
25	Hinge Axes		1
26	Top Cover		1
27	Screw		7
28	Top Clip		3
29	Top		1
30	Top Card		1
31	Box part		1
32	Bottom Hinge		1
33	Hinge Fixed Screw		3
34	Fixed Foot		1
35	Wheel		2
36	Axes		2
37	Adjustable Foot		1
38	Vegetable Case		1
39	Box Cover II		2
40	Box cover I		1

PARTS LIST KD-212F

[illegible]

TROUBLE SHOOTING

Thermostat		Repair Procedure <ol style="list-style-type: none"> 1. Open the Refrigerator Door. 2. Remove Thermo Cover 3. Adjust Thermo Knob to OFF position and pull out the Thermo Knob from Thermostat.. 4. Pull out the Screw from Thermo Box. 5. Dig out Thermostat to unlock and pull out Thermostat from Thermo Box 6. Short the thermostat terminal and check if compressor runs. 7. Pull out electrical wire from thermostat by gripping the plug if compressor does not runs 8. Replace thermostat 9. After replacing Thermostat, reverse steps above.
PTC Starter		Repair Procedure <ol style="list-style-type: none"> 1. Release Relay Cover Fixing Clip. 2. Remove Relay Cover. 3. Remove PTC Starter (change overload protector together) 4. Pull out PTC Starter, check value of resistance with given value, 5. Hold receptacle terminal then pull electrical wire from PTC Starter. 6. After replacing PTC Starter, reverse the steps above.
Overload Protector		Repair Procedure <ol style="list-style-type: none"> 1. Check for continuity on overload protector, if open 2. Pull out Overload Protector. 3. Hold receptacle terminal then pull electrical wire from Overload Protector. 4. Replace overload protector.

Cause	Check Point	Correction
Compressor	Check coils resistances	Repair Procedure <ol style="list-style-type: none"> 1. Replace compressor if measured resistances differ from given standard.
Not cooling	Check thermostat setting	Repair Procedure <ol style="list-style-type: none"> 1. Operate unit for 20 minutes with thermostat set at maximum setting.
Insufficient cooling	Check gasket gap	Repair Procedure <ol style="list-style-type: none"> 1. Check if gap can be resolved by adjustment of door fixing screws. 2. Replace worn or warp door gasket 3. Defrost if abnormal accumulation of frost more than 10mm.
Malfunction due to leaks or clogged system	Charged (purge) with nitrogen into the refrigeration system & check for leaks on welds or clogs	Repair Procedure <ol style="list-style-type: none"> 1. Check for clog or leak in the cooling system. 2. Repair or replace the clogged or leak section. 3. Change filter dryer. 4. Purge with nitrogen to clean and check for leaks 5. Recharge refrigerant and test run.

TROUBLE		INSPECTION		CAUSES		REMEDY
---------	--	------------	--	--------	--	--------

No Power		Check electric power supply voltage		Open circuit breaker or fuse		Fix or replace
		Check electrical circuit		Open Fuse		Replace
				Worn out or defective A/C cord		Replace
No Light		Check lamp		Open		Replace
		Check lamps socket		Corroded		Replace

Low Cooling		Check for thermo setting		Setting too low		Set thermostat higher
		Check leaks		Deform or warp door gasket.		Adjust door fixing screws or replace gasket
				Poor weld on joints		Repair, purge with nitrogen & re-charge refrigerant
				Over storage or load or heavy frost accumulation		Reduce or re-arrange load or defrost unit

Defective Cooling System		Check Thermostat		Check if compressor runs by shortening thermostat if not		Replace thermostat
		Check PTC starter resistance against given value		No resistance or differ from given value		Replace PTC starter.
		Check Overload Protector		Check for continuity		Replace if open.
		Check for leaks		Leaks or poor welds on joints		Repair, re-weld, purge, vacuum and recharge refrigerant
		Check Compressor resistance against given specification		Defective		Replace, weld, purge, check for leaks and re-charge refrigerant.
		Check Pipe System		Clogged Pipe System or oil choke		1. Purge with nitrogen to remove clogs 2. Repair or replace clogged section, vacuum, purge, check leak and re-charge refrigerant.